

ARCHITECTURAMA

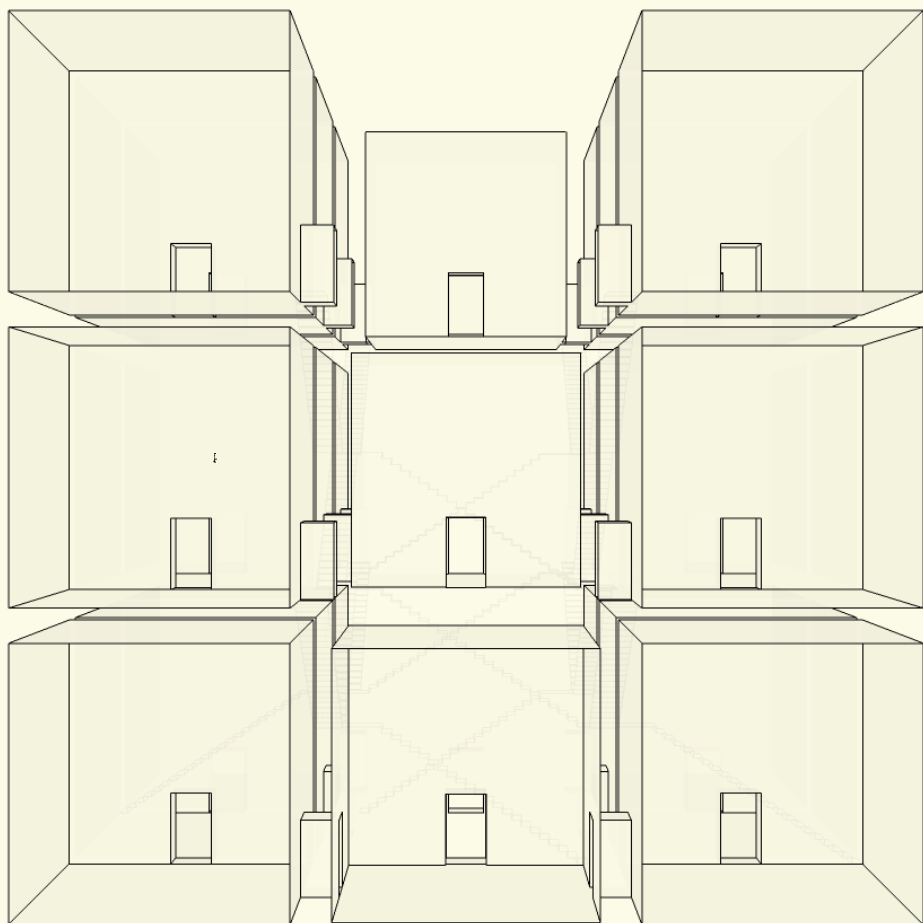

A museum today is often at once, cultural center, conference venue, architectural icon, city landmark, educational tool, research center, restaurant, shop, etc.
The functional program of a typical museum includes a large proportion of specialized and dedicated space. For example auditoriums, offices, group entrance, cafeteria, reception desk, etc.

year: 2014 location: Toronto, On
client: The Museum of Contemporary Canadian Art (MOCCA)
program: open call for ideas for the «TBD» exhibition, asking «what is a contemporary art gallery?»

MOVING – UNMOVING

WINNER
Project selected for the exhibition

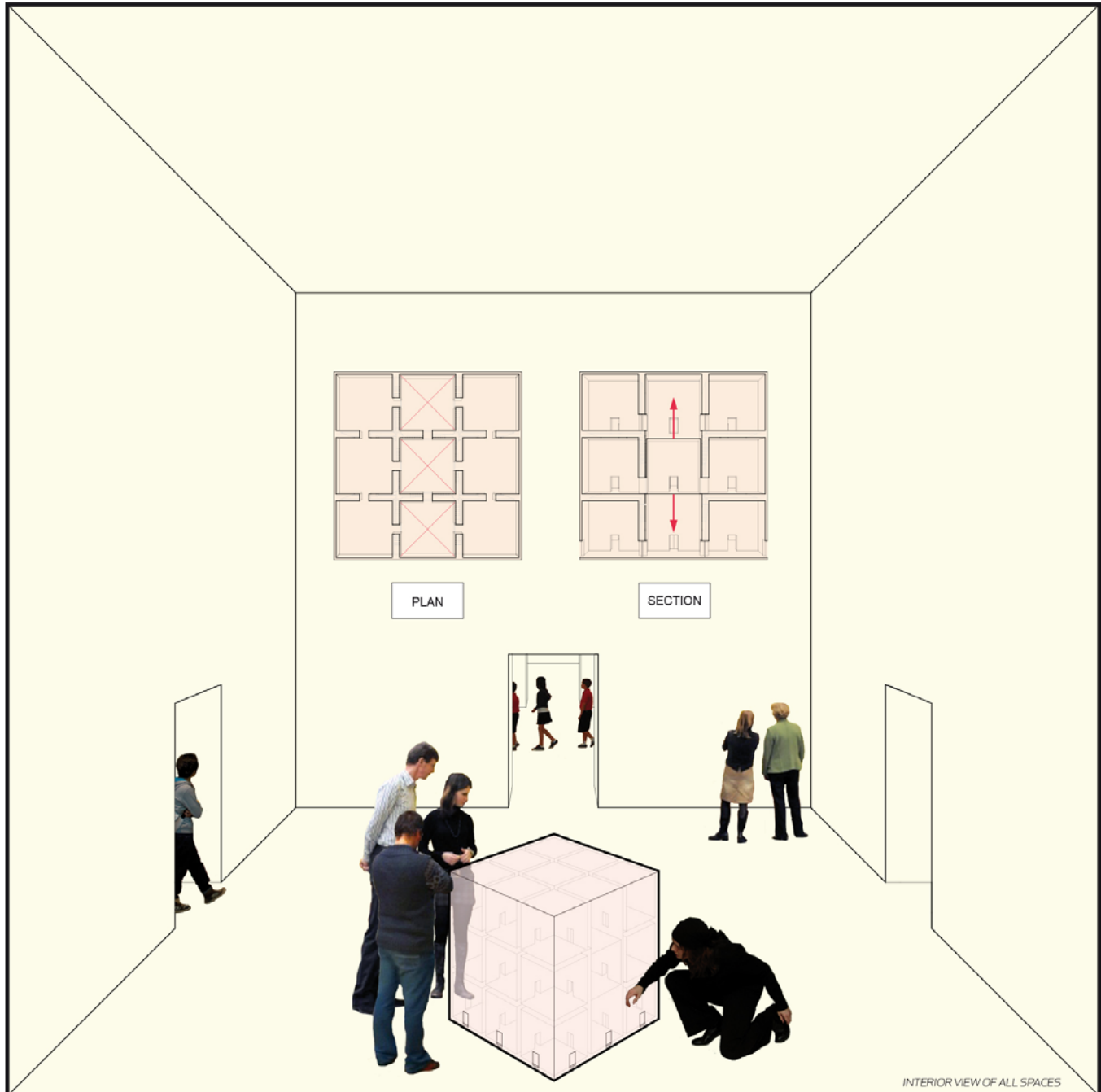

Our proposal is one neutral space unit, stackable and universal
All galleries are identical and perfect
Some are movable for vertical connections (giant lift)
Almost every square meter is exhibition space
No entrance hall, no circulation spaces = uninterrupted visit
Fire exit and mechanical equipment are hidden in thick walls
Visitor services are freely provided anywhere taking advantage of technology